

Explorer 1

Wednesday, 01 October 2008 17:14 [Assembly Instructions - guitars](#)



1. Assemble the body

1_1. body-A treble side



1_2.

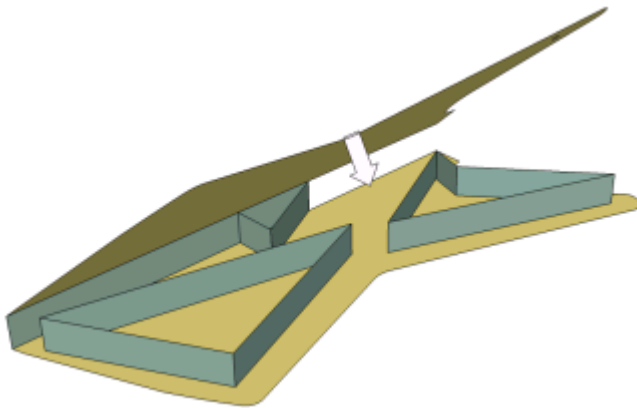

1_3. 1_2 + body side



1_4.

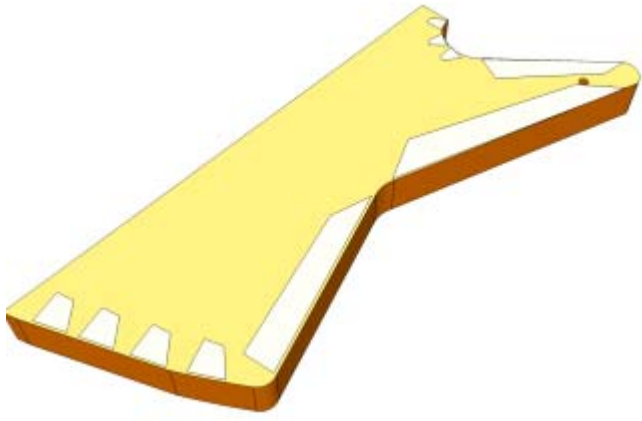

Repeat the above steps with the body-A bass side.

1_5. body-A bass side + neck socket + body-A treble side

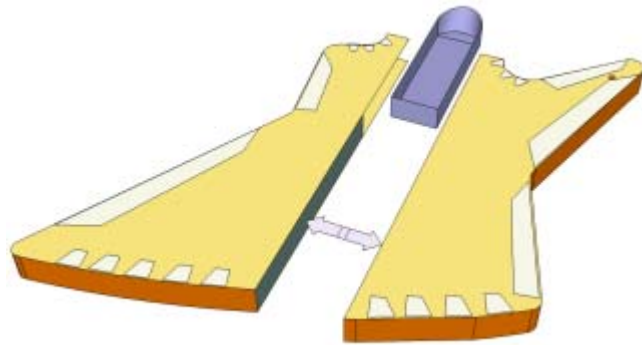

1_6.

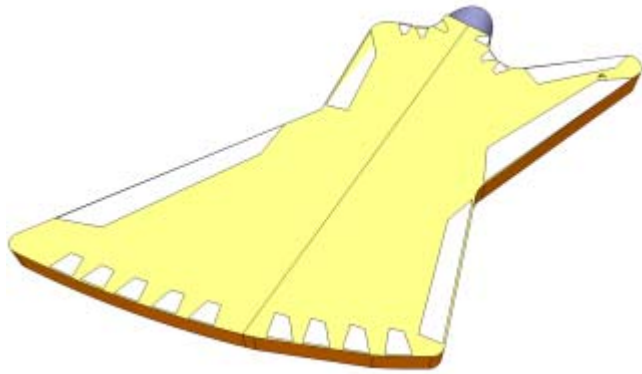

1_7 body top-B + 1_6 + body back-B

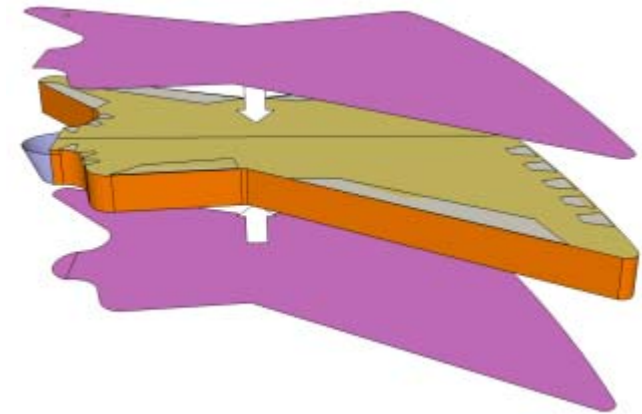

1_8. body top-C + pickups + bridge + pickguard + 1_7 + Body back-C

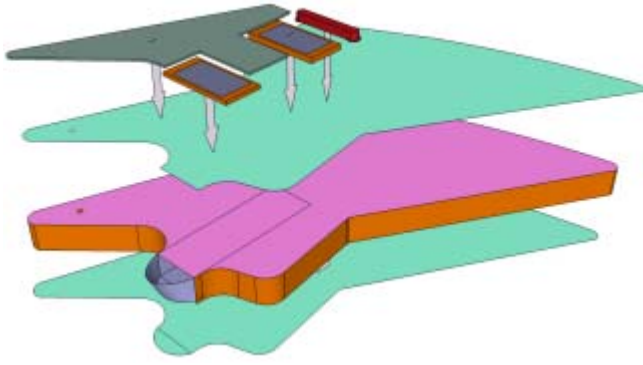

1_9.

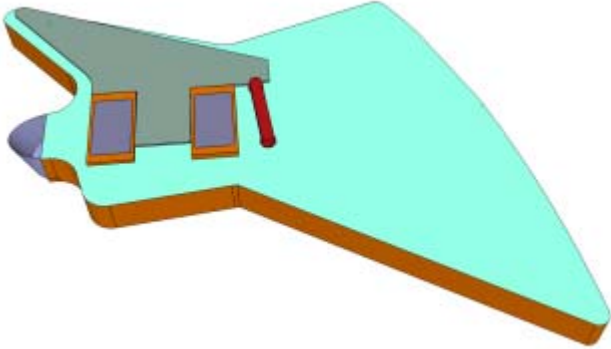

2. Assemble the neck

2_1

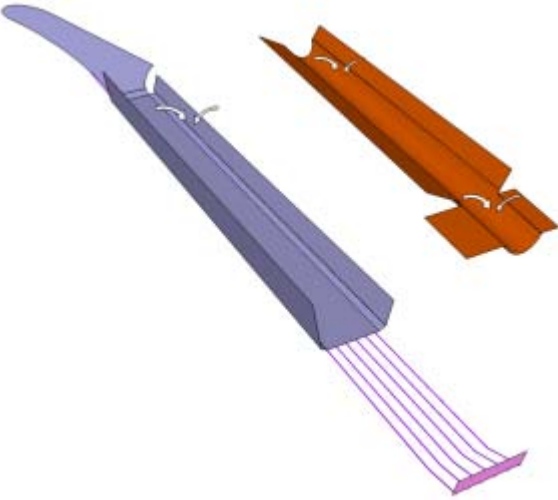

2_2.

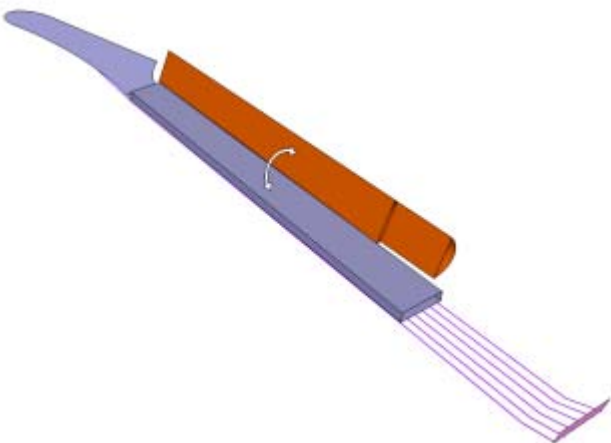

2_3. headstock



2_4. 2_3 + tuners

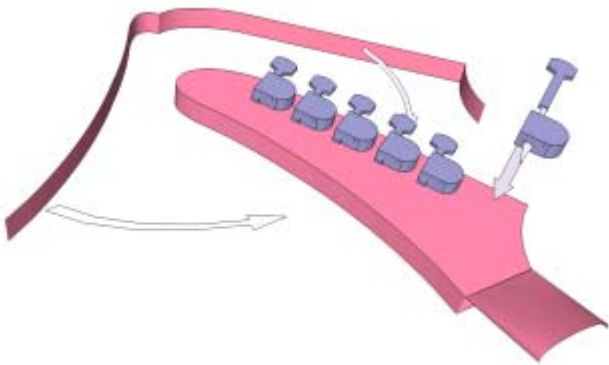

2_5. 2_2 + 2_4

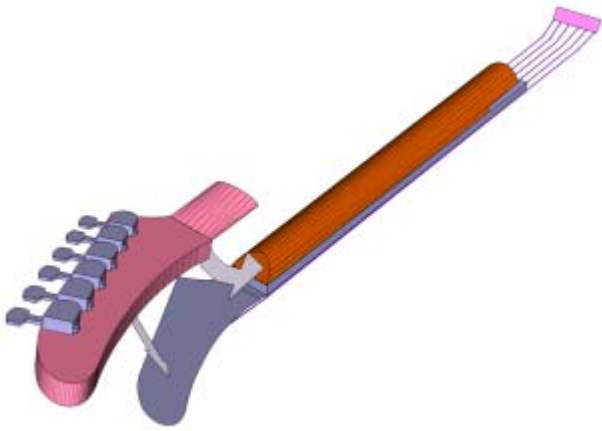

2_6. 2_5 + tailpiece

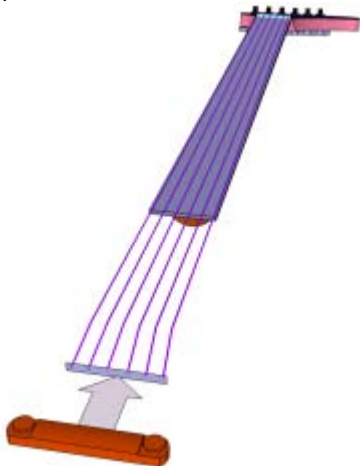

3. Install the neck onto the body.

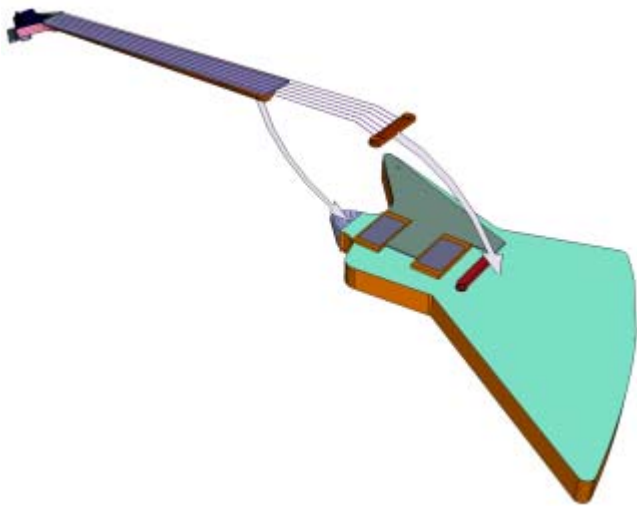

4. 3 + knobs

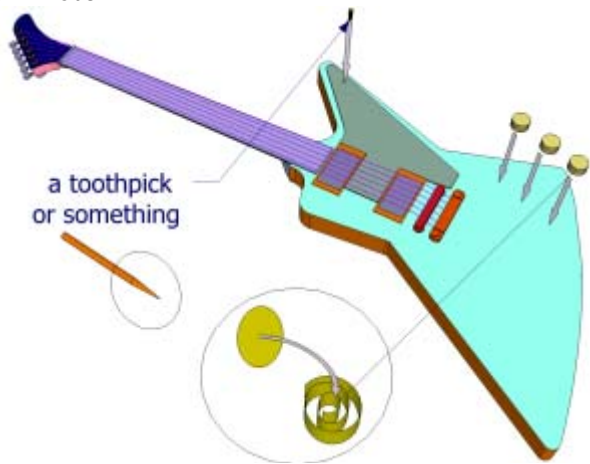

5.

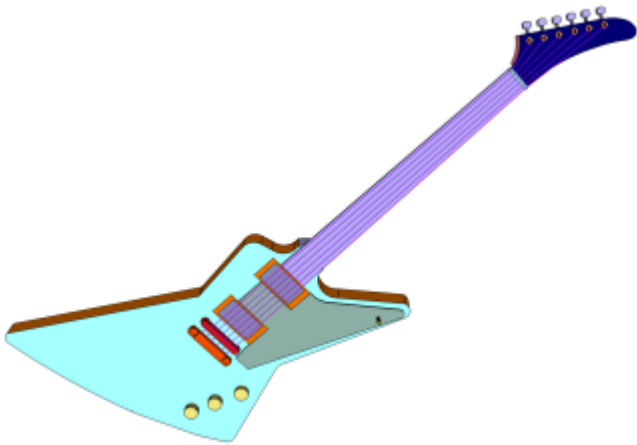

Last Updated on Sunday, 17 November 2013 10:55